

Inquiry

KS Production Equipment

Fax: +49(0)821/797 - 1896

Date:

Company:*

Plant:

Name, Surname:*

Department:

Telephone:*

Telefax:

e-mail:*

Please contact us

Senden Sie uns ein Angebot

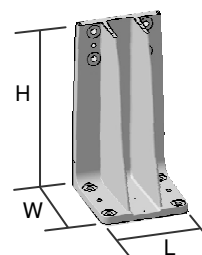

KUKA Werkzeugkonsolen (Auswahl-Tabellen)

| Pedestal base (aluminum) | | | |
|--------------------------|---------------------|------------|-----|
| Height* | Order designation | SAP no. | Qty |
| 100 | 36.245-06.100.00-30 | 90-201-416 | |
| 150 | 36.245-06.100.00-31 | 90-196-535 | |
| 200 | 36.245-06.100.00-32 | 90-196-536 | |
| 200 | 36.245-06.100.00-59 | 90-196-540 | |
| 250 | 36.245-06.100.00-58 | 90-196-541 | |
| 300 | 36.245-06.100.00-57 | 90-196-537 | |
| 350 | 36.245-06.100.00-56 | 90-196-539 | |
| 400 | 36.245-06.100.00-60 | 90-414-509 | |
| 500 | 36.245-06.100.00-61 | 90-414-510 | |
| 600 | 36.245-06.100.00-62 | 90-414-511 | |

| Pedestal base (steel) | | | |
|-----------------------|-------------------|------------|-----|
| Height* | Order designation | SAP no. | Qty |
| 100 | 829.003-03.006.01 | 90-659-866 | |
| 150 | 829.003-03.006.02 | 90-659-867 | |
| 200 | 829.003-03.006.03 | 90-659-868 | |
| 200 | 829.003-03.006.11 | 90-659-869 | |
| 250 | 829.003-03.006.12 | 90-659-870 | |
| 300 | 829.003-03.006.13 | 90-659-871 | |
| 350 | 829.003-03.006.14 | 90-659-872 | |
| 400 | 829.003-03.006.21 | 90-659-873 | |
| 500 | 829.003-03.006.22 | 90-659-874 | |
| 600 | 829.003-03.006.23 | 90-659-875 | |

* The length L and the width W depends on the height H. They are separated into three groups:

H: 100-200mm (205) --> L: 105mm B: 125mm;

H: 200-350mm --> L: 154mm B: 152mm;

H: 400-600mm --> L: 190mm B: 202mm

| Subframes | | | | | | | |
|--------------------|----------|---|---------|---|----------|-------------------|-----|
| Type | Lenght B | x | Width A | x | Height H | Order designation | Qty |
| Plate base | | | | | | 829.003-02.150... | |
| Tool plate | | | | | | | |
| Beam bbase | | | | | | 829.003-02.250... | |
| Tool plate | | | | | | | |
| Double footed base | | | | | | 829.003-02.550... | |
| Tool plate | | | | | | | |

* = mandatory fields

