

# KUKA

KUKA Energy Solutions

## KUKA ROBO LOAD



■ **KUKA ROBO LOAD**  
**AUTOMATIC GLASS UNLOAD**  
**AND FOIL LAY-UP**

This solution combines glass loading and foil lay-up in one station.

Glass is unloaded from a rack with safety doors on both sides. Double bay design allows replenishment without line stop.

A glass washer can be incorporated in this station as well as the first foil lay-up from a foil sheeter.

The robot is equipped with a dual end effector for glass and EVA sheets.

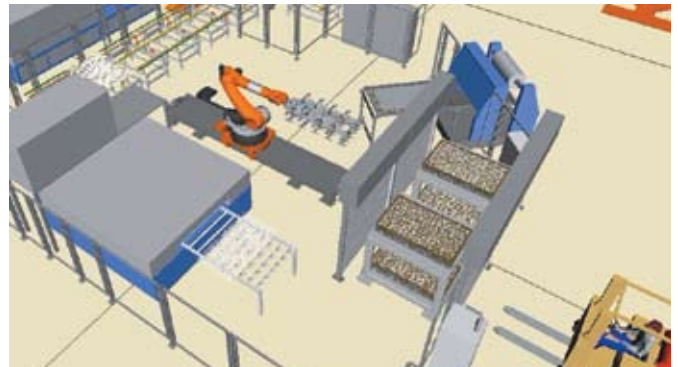

LAYOUT EXAMPLE

COMPONENTS	BASIC SCOPE	OPTIONS
■ Robot	■	
■ End Effector	■	
■ (2) Glass Racks	■	
■ (2) Safety Rolling Doors	■	
■ Cell Control by Robot Controller KRC	■	
■ Safety Fence	■	
■ Foil Sheeter "Standard"	■	
■ Foil Sheeter "Quick Load"		■
■ Foil Sheeter "Redundant"		■
■ Glass Washer Vertical		■
■ Glass Washer Horizontal		■
■ Glass Inline Inspection		■
■ PLC Siemens S7 or others		■
■ Linear Axis for Robot		■
■ Bar Code Label		■
■ Material Tracking / MES Interface		■

TECHNICAL DATA	
Glass Stack:	Pallet or L-frame with Cord Separators
Glass Size:	Variable
Cycle Time:	30 sec
Foot Print:	Starting at 6 m x 8 m
Price:	On Request



Specifications regarding the characteristics and usability of the products do not constitute a warranty of properties. They are intended to serve informative purposes only. Some items of equipment depicted in the illustrations are optional, and are not included in the standard scope of supply. Solely the respective contract of sale shall be binding in respect of the extent of our supplies.

For more details contact us at [solar@kuka.de](mailto:solar@kuka.de) or call + 49 821 797-1076

**KUKA Systems GmbH**

Bluecherstrasse 144 | 86165 Augsburg | Germany  
 Tel. + 49 821 797-0 | Fax + 49 821 797-1991  
[info@kuka.de](mailto:info@kuka.de) | [www.kuka.com](http://www.kuka.com)

**International**

Benelux | Brazil | China | France | Germany | India | Mexico  
 Norway | Russia | Slovakia | South Korea | Sweden | UK | USA

